

RURAL MUNICIPALITY OF ROSEDALE NO. 283

PUBLIC NOTICE

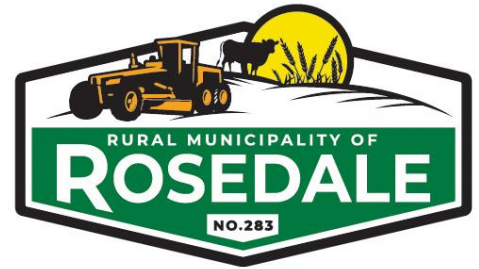

Public notice is hereby given that the Council of the Rural Municipality of Rosedale No. 283 (the “RM”) intends to consider adopting a bylaw under *The Planning and Development Act, 2007* to adopt a **new Zoning Bylaw**.

THE INTENT

Proposed **Bylaw No. 16/2025** will replace **Bylaw No. 3/99** and all its amendments. The new Zoning Bylaw implements the RM’s Basic Planning Statement and establishes regulations, districts, permitted and discretionary uses, administrative procedures, and development standards to guide future growth and development within the RM.

AFFECTED LAND

The Zoning Bylaw and Zoning District Map apply to all lands within the RM. In addition, a new Highway Commercial District is proposed for part of the NW ¼ Section 06-31-03 W3M, as shown below. Copy of the full Zoning District Map is available online at <https://rm283rosedale.ca/>.

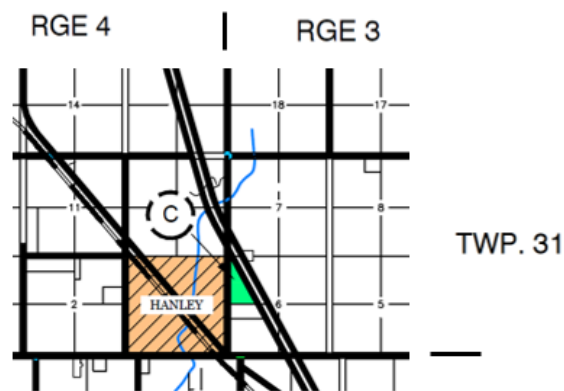

REASON

To regulate land use and development in the RM in the interests of public health, safety, amenity, and general welfare, and to implement the RM’s planning policy framework.

PUBLIC INSPECTION

The proposed bylaw and map may be inspected at the RM Office, PT NW 36-30-04 W3, Rural Municipality of Rosedale No. 283, Saskatchewan, Monday–Friday, 7:30 a.m.–12:00 p.m. and 12:30 p.m.–3:00 p.m. (excluding statutory holidays). Copies are available at cost. The bylaw and map may also be viewed online at <https://rm283rosedale.ca/>.

PUBLIC HEARING

Council will hold a public hearing on December 9, 2025 at 2:00 p.m. in the Council Chambers at PT NW 36-30-04 W3 (RM Office). Any person or group may appear or file a written submission concerning the proposed bylaw. Written comments must be received by 2:00 p.m., December 9, 2025 at the address above or by email to rm283@sasktel.net.

Issued at the R.M. of Rosedale No. 283 this 10th day of November, 2025

Danielle Thall
Administrator